

JETE

USER MANUAL

SMARTWATCH VOLT 2



Please read the instructions carefully before using the product

Introduction :

Thank you for purchasing JETE products. For optimal and safe performance, it is expected to read the instructions carefully before using this product.

Package Content :



JETE-VOLT

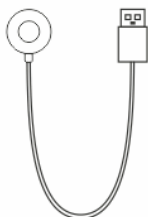

Cable Charging



User Manual

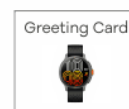

Greeting Card

How to Install and List Applications :

1. Enter the playstore / App store, you can also scan the QR on the packaging
2. Download and install the "JETE CONNECT" application.
3. For the first user, you must register first.
4. Click on the "register" section.
5. Fill in your personal data completely and click register.
6. After successful registration, then log in with the registered account.

Selamat datang
Hai, Saya Partner Pintar Anda. Mari Mulai Hari Anda

Email

Password

Login

atau lanjut dengan

Belum Punya Akun? Register

Reset Password?

Halo
Bersama Partner Pintar,
Jadikan Setiap Harimu Lebih Baik

Name
JETE

Email
jeteindonesia@gmail.com

+62 XXX-XXXX-XXXX

Password
ilovejete

Konfirmasi Password
ilovejete

Agree and Register

atau daftar dengan

Selamat datang
Hai, Saya Partner Pintar Anda. Mari Mulai Hari Anda

Email

Password

Login

atau lanjut dengan

Belum Punya Akun? Register

Reset Password?



App Store: JETE CONNECT



Google Play: JETE CONNECT

QR Aplikasi
"JETE CONNECT"



Notes: This application can analyze the data you provide every day, you can also manage the smartwatch through the JETE CONNECT application such as profile, smartwatch display, notifications, exercise and various other settings.

How to Connect With a Smartphone :

1. Turn on the bluetooth function on the smartphone
2. Enter the "JETE CONNECT" application.
3. Select the "DEVICE" menu.
4. Click "Pair DEVICE".
5. Search and select "JETE-VOLT".
6. Make sure the MAC address matches your smartwatch by going to the settings in Smartwatch ---> About.
7. After that there will be a notification on the smartwatch and also the application to immediately confirm the pairing.
8. Then click the check mark on the smartwatch.
9. You can check whether the connection was successful or not through the "JETE CONNECT" app.
10. The blue connection icon on the smartwatch indicates successful app pairing "🔗".
11. Next enter the bluetooth settings on your smartphone.
12. Search and select "JETE-VOLT".
13. Then juxtapose.
14. Blue and orange connection icons on the smartwatch indicate successful pairing of the app and bluetooth "🔗".

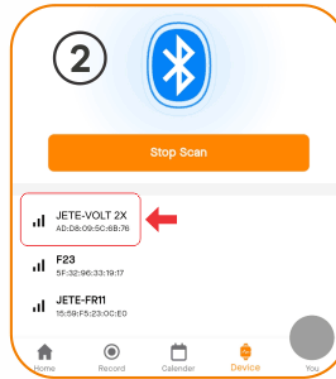
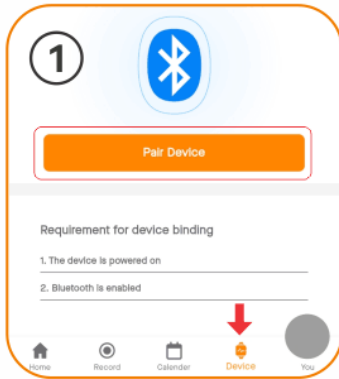

How to Charge :

1. Connect the USB port with the Charger head.
2. Attach the smartwatch with the Charger Cable.
3. Make sure the charging sign appears on the smartwatch screen.
4. Disconnect the charger cable immediately after the battery is fully charged.
5. Do not forget to clean the Charger cable before charging.
6. Charger cables that are dirty or wet will risk an electrical short circuit.

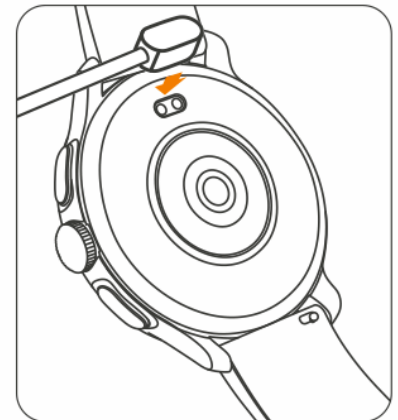

How to Use :

How to Change Wallpaper at smartwatch :

How to Change wallpaper at smartphone :

1. Long press on the smartwatch screen
2. Swipe to select the wallpaper.
3. Then Click to confirm
4. You can also rotate the round button on the smartwatch to change the Walpaper.



Notes:

Download more interesting Walpapers via the JETE CONNECT app by :

1. Open the JETE CONNECT app.
2. Select the "Device" menu .
3. Click "Watch Face" .
4. You can choose Online Dial (100+ options available).
5. You can also choose Custom Dial via image from smartphone gallery.

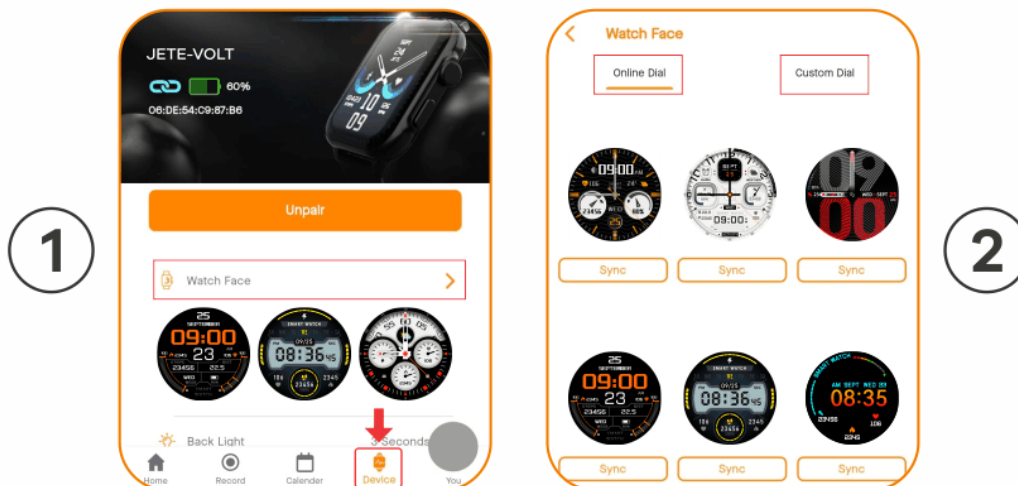

GPS Feature :

GPS Feature on Smartwatch JETE-VOLT 2 allows you to track various sports activities such as running, cycling, or hiking with great accuracy. To obtain optimal results, make sure you synchronize the GPS before starting the activity.

Steps:

1. Pastikan Koneksi Bluetooth Aktif:
 - Make sure your smartwatch is connected to the JETE CONNECT application on your phone.
2. Synchronize GPS Data:
 - Go to the device menu.
 - Look for the feature "GPS Synchronization" or "AGPS Syncing".
 - Tap this option and wait until the synchronization process is 100% complete. This process will download the latest GPS data to your smartwatch so your location can be determined faster and more accurately.
3. Activate Sports Mode:
 - Open the sports menu on the JETE-VOLT X2 smartwatch.
 - Select the type of sport you want to perform (running, cycling, etc.).
 - Wait a few moments until the GPS is successfully connected.
4. Start Exercising:
 - Tap the start button to begin recording your sports activity.
 - The GPS will automatically track routes, distances, and other data during your activity.

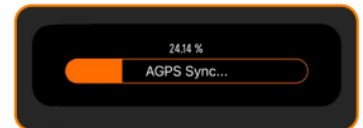
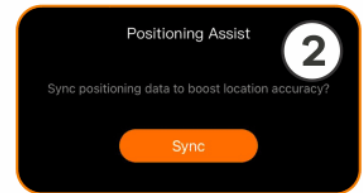
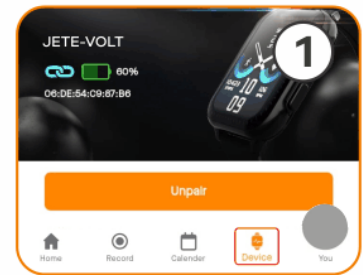

Sports / Exercise :

The JETE smartwatch supports various sports such as fitness, relaxation, ball games, and dance classes. Including: walking, running, treadmill, climbing, cycling, spinning, yoga, basketball, football, badminton, and several other sports. Equipped with customizable sports modes that can be adjusted to your favorite activities.

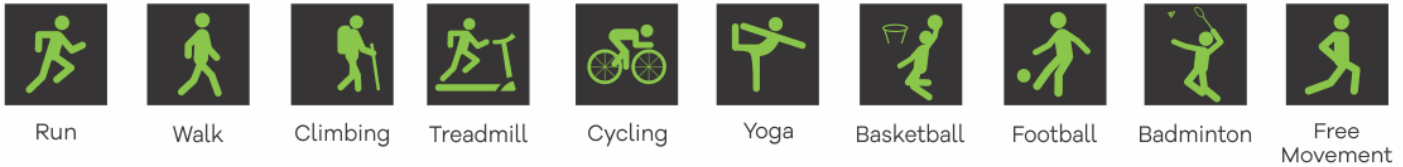

You can select a sport by :

1. Press the button on the right side of the smartwatch to enter the menu.
2. Choose a sport/exercise.
3. Tap to confirm.
4. If you want more sport options, click "Personalization."



Stress Monitor :

After properly using the smartwatch, open the "Stress" menu on the smartwatch to check how much psychological pressure you are experiencing.



Mood :

Accurately detects four emotions (happiness, calmness, anxiety, and irritability) to help you adapt better.



Heart Rate :

Wear the smartwatch properly — not too tight and not too loose. Make sure the green light under the smartwatch is on.

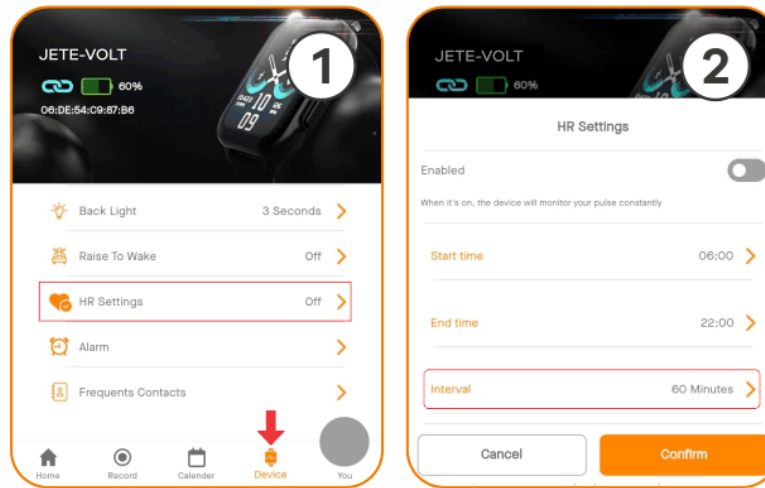

There are 2 ways to use the heart rate feature :

1. Go to the Heart Rate menu on the smartwatch, then wait until the result is displayed.
2. Set automatic measurement at intervals (every few minutes) through the Interval menu in the JETE CONNECT app.

Activity :

After using the smartwatch properly, open the Activity/Record Track menu on the smartwatch. It will show the number of steps, calories, distance, and several other parameters throughout the day.

PAI (Personal Activity Intelligence) :

Calculates your physical activity level based on heart rate and movement intensity. A higher PAI value reflects more intense activities and better overall health conditions.

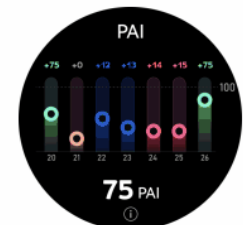

SPO2

After properly using the smartwatch, open the "Blood Oxygen" (SPO2) menu on the smartwatch. It will take some time to measure the blood oxygen level, then wait until the result is displayed.



Breathing Exercise:

Berfungsi sebagai alat bantu untuk melatih pernapasan.

Sleep:

You can control your sleep regularly by :

1. Wear the smartwatch while sleeping.
2. Open the Sleep menu.
3. Then go to sleep.
4. The smartwatch will record your sleep status throughout the night.

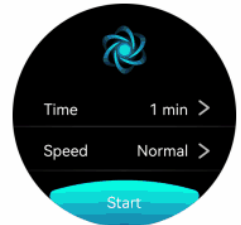

Alarm :

You can set up to 5 alarms by:

1. Open the JETE CONNECT app.
2. Select the Device menu.
3. Tap Alarm.
4. Tap Add Alarm.
5. Set the alarm time.
6. Then tap Add alarm.
7. Don't forget to activate the alarm.

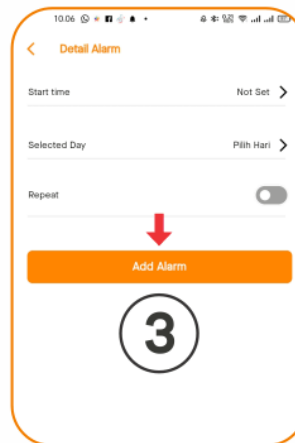
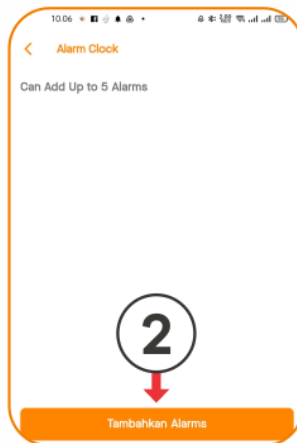
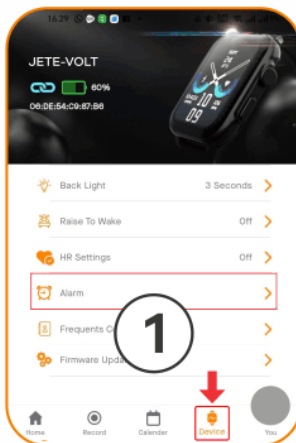

Notifications :

You can view messages sent to your smartphone through the smartwatch. Set which applications you want notifications from via the "JETE CONNECT" app.

Calls:

In the call menu, there are 3 functions:

1. Save important contacts into the smartwatch.
2. View call history.
3. Dial a phone number directly.

Note : The smartwatch supports Bluetooth calls. You can answer, end, or even reject calls directly from the smartwatch.

Contacts:

Fitur yang berfungsi untuk menyimpan kontak pada smartwatch

1. Open the "Frequent Contacts" feature in the Device menu.
2. Select the " 👤 " icon.
3. Choose the contact you want to save to the smartwatch.

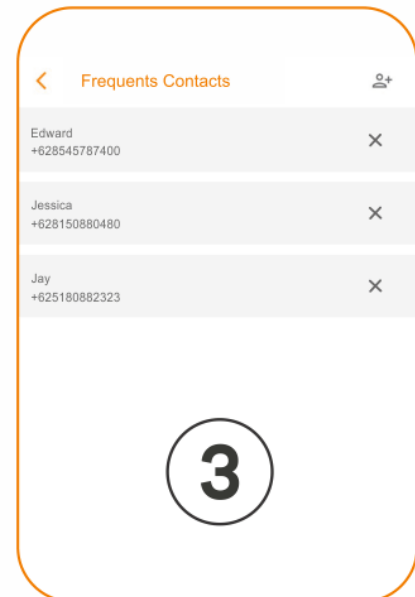
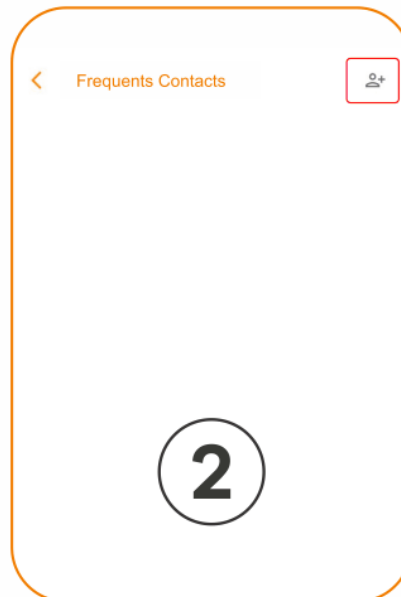
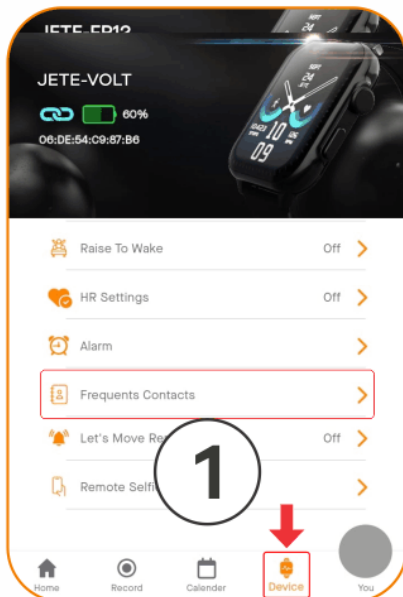
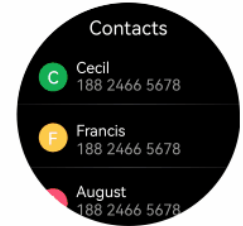
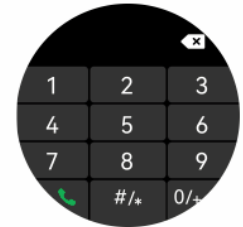
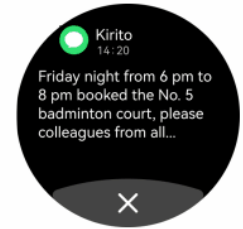

Altimeter:

A feature that functions to measure the altitude of a point above sea level.



Barometer:

A feature that functions as a tool to measure atmospheric pressure.



Compass:

1. Select the compass feature from the settings menu.
2. Calibrate the compass by moving it in a figure-eight motion slowly.
3. After calibration is complete, the smartwatch will display the image as shown below



Music Player:

In the Music Menu, there are several functions:

1. Play/Pause.
2. Next/Previous Music (Skip track).
3. Adjust Volume.
4. You can also play music directly from the smartwatch.

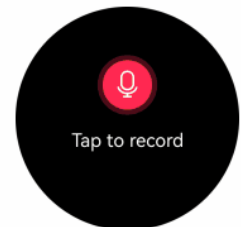

Voice Recorder:

The Voice Recorder feature allows you to record clear, high-quality audio directly from the smartwatch.

Album :

Use the Album feature in the app to transfer your favorite photos to the smartwatch and enjoy beautiful moments anytime.

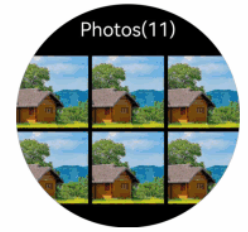

Remot Kamera :

You can use the smartwatch as a remote for selfies by following these steps:

1. Open the JETE CONNECT app.
2. Select the Device menu.
3. Tap Remote Selfie.
4. Select the Camera menu on the smartwatch.
5. Place your smartphone at a reasonable distance.
6. Tap Take Picture on the smartwatch.

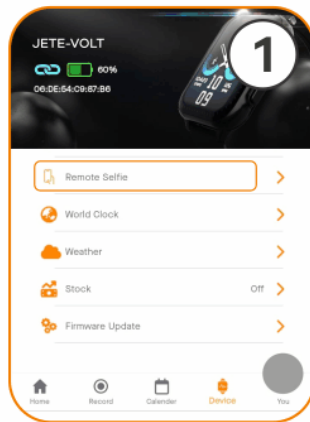

Klik disini

Reminder

Set various types of reminders such as meetings, sleep, and schedules in the app. The smartwatch will display these reminders, allowing you to receive notifications accurately and on time.

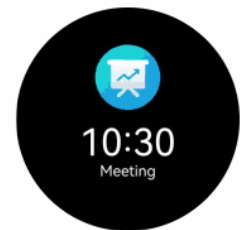

Suara :

A feature that functions to activate Google Assistant or Siri on your smartphone.

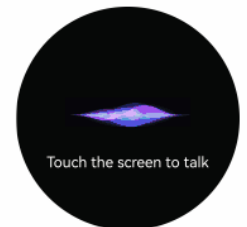

SOS (Save Our Souls) :

1. Select the "SOS" menu on the smartwatch and activate the "SOS" function.
2. Enter the number to be registered.
3. It will automatically call the registered number.



Game :

This smartwatch comes with 4 casual games: Flappy Bird, 2048, Dice, and Air Combat. Enjoy these games anytime, anywhere.

Pomodoro Timer :

Set the reminder duration to start "Focus Time." When the countdown ends, the smartwatch will remind you, then switch to "Break Time." After the break countdown is complete, the smartwatch will remind you again.

TWS :

This smartwatch supports connection to earbuds, allowing you to play music directly from the watch while exercising, helping you stay focused and improve the quality of your workout.

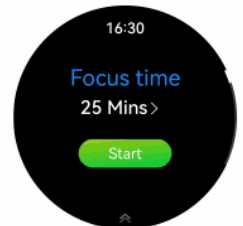



Calculator

For calculating.



Calendar

For checking dates.



E Card

For saving Barcodes.



Weather

For viewing the weather.

World Clock :

You can see the time in various countries by:

1. Open the "JETE CONNECT" application.
2. Select the "Device" menu.
3. Click "World Clock".
4. Click "Tambahkan Jam" (Add Clock).
5. Select the desired country.

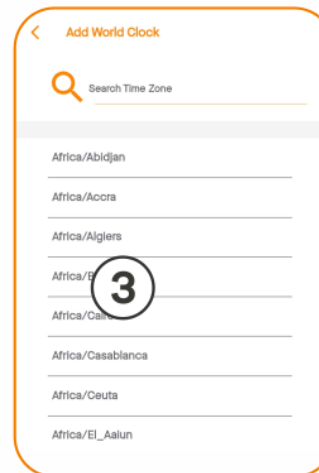
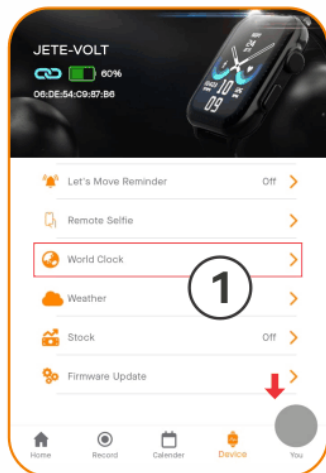
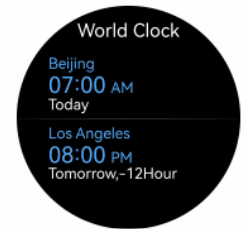

You can view the stock market by:

1. Open the "JETE CONNECT" application.
2. Select the "Device" menu.
3. Click "Pasar saham/stock" (Stock market/stock).
4. Activate the stock market toggle.
5. Click "Tambah Stok" (Add Stock).
6. Select the desired stock market.

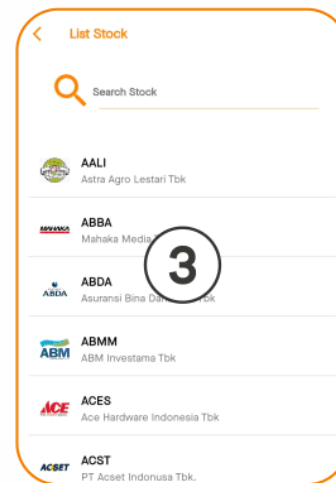
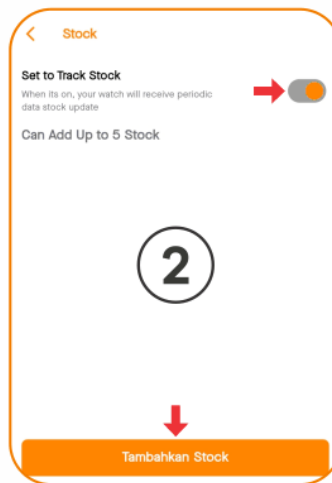
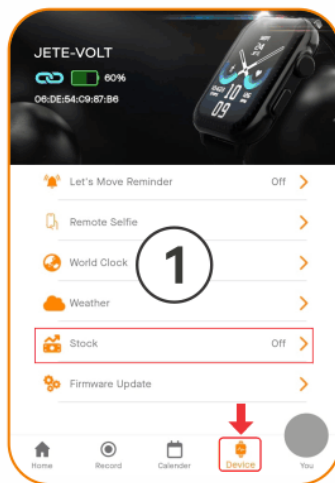
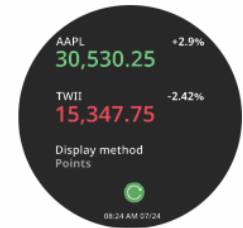

Countdown/Timer

Used to set a countdown from a specific value. It is useful for sports, cooking, presentations, or tasks that require limited time supervision.

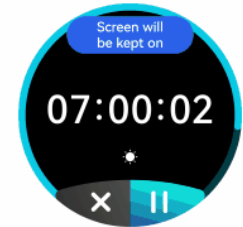

Stopwatch

Used to accurately measure time, whether in sports, research, training, or other needs.

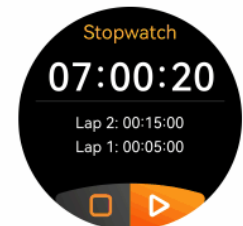

Find Phone :

You can find your smartphone by:

1. Make sure the smartwatch is connected to the smartphone.
2. Select the "Find Phone" menu on the smartwatch.
3. Your smartphone will automatically ring.
4. This feature will only work if you have the "JETE Connect" application open.



Anti-Loss Notification :

When the smartwatch is disconnected from the smartphone because the distance is too far, the smartwatch will make a sound and vibrate. This function is set through the "JETE CONNECT" application.

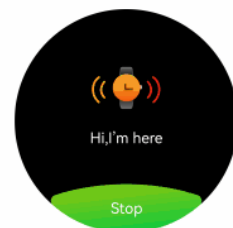

Shortcut Menu :

From the smartwatch's main screen display, swipe down to access:

1. Bluetooth 3.0.
2. Screen stays on for 5 minutes.
3. Raise to Wake.
4. Brightness.
5. Flashlight.
6. Settings.
7. Do not disturb mode.



Specifications :

Screen Size	:1.43" HD
Screen Resolution	:466*466 Pixels
Battery Capacity	:450mAh
BT Range	:8-10m
Working Time	:3-5 Days
Standby Time	:15 Days
Body Material	:Zinc alloy
Band Material	:Silicone Strap
Machine Weight	:42g

Problem :

Heart rate signal missing

The smartwatch continuously monitors your heart rate during daily activities and workouts. Sometimes the smartwatch reading may be inaccurate. If this happens, the missing heart rate will appear as dotted lines.

If you cannot obtain a heart rate signal, first ensure that you are wearing the smartwatch correctly. Avoid placing it too high or too low on your wrist, and do not wear it too tight or too loose. After adjusting it, tap the heart rate icon to collect data. If the heart rate data still does not appear, check the heart rate function in the app and make sure it is activated.

Other Problem :

If your phone cannot connect to the smartwatch, open the Bluetooth settings on your phone and check whether the smartwatch signal is available. If it appears but still has issues, check whether the smartwatch is connected to another device. If so, disconnect it.

iOS users should go to Settings – Bluetooth – Forget Device and reconnect.

Caution :

1. Heart rate, blood oxygen, and other data from the smartwatch cannot be used as a diagnostic reference.
2. Self-diagnosis and self-treatment are dangerous. Only professionals can diagnose heart conditions and other illnesses. Consult a doctor for proper examination.
3. Heart rate and other data measured by the smartwatch may not be completely accurate due to external interference, improper usage, or the user's physical condition.
4. Do NOT take medication or undergo treatment based solely on smartwatch data. Always follow a doctor's recommendation. We are not responsible for any inaccuracy or consequences arising from the provided data.

JETE

WARRANTY CARD and USER MANUAL

SMARTWATCH VOLT 2



e-Usermanual

IMPORTIR

PT. DORAN SUKSES INDONESIA

Jl. Lebak Jaya 2 Tengah No. 2, Surabaya

CUSTOMER SERVICE

 081217393609

 jete.id  jeteindonesia

 jeteindonesia  jeteindonesia

How to Warranty Claim JETE Product :

1. All warranty claims can be made at the list of Authorized Outlets listed on the warranty card.
2. Buyers can come to an authorized Outlet or contact Customer Service +62812-1739-3609 if they want to exchange the product online.
3. All expedition shipping costs / product postage are borne by the buyer.
4. When claiming the warranty, the buyer is MANDATORY to show the completeness of the warranty:
 - A purchase receipt that clearly states the name of the outlet and the date of the transaction.
 - The product must still be within the specified warranty period.
 - Warranty card that has been filled out.
 - Box / Packing Product.
5. Please inform the constraints / product damage that occurs to our staff.
6. WARRANTY DOES NOT APPLY if USER DAMAGE is found, namely:
 - BROKEN, CRACKED, BURNED, DROPPED, MODIFIED BY YOURSELF, SUBMERGED IN WATER.
7. If there are problems during warranty claims or other questions, please contact Customer Service +62812-1739-3609.

Terms and Conditions of Warranty :

1. This warranty is valid for 2 years for original JETE products.
2. This warranty is valid for the warranty period stated on the product packaging since the date of sale.
3. During the warranty period, the user is exempt from any replacement costs that may occur.
4. The user must show the warranty card and purchase receipt when applying for a warranty.
5. The warranty applies to functional damage:
 - Disfunction.
 - Audio not detected.
 - Indicator off.
 - Battery damage.
6. This warranty DOES NOT APPLY if:
 - PRODUCT IS BROKEN, CRACKED, BURNED, FALLEN,
 - MODIFIED YOURSELF, SOAKED IN WATER.
 - Supporting accessories such as: cables, adapters, etc.
 - Abnormal use, not stored properly, natural disasters, modified, or anything intentionally.
 - The product has been repaired by a third party.
 - The data is not filled in completely by the seller and buyer.
 - Damage caused by user error.
 - The product warranty period has expired.

**2 YEARS
WARRANTY**



Contact Us

JETE WARRANTY POINTS

